



Handwritten notes on the left side of the page, including a small calculation:

$$\begin{array}{r}
 10 \\
 + 1.50 \\
 \hline
 11.50
 \end{array}$$

Other illegible handwritten text follows.

Handwritten notes in the middle section, appearing to be a list or account entries in Hindi. Some legible words include 'मूल्य', 'वस्तु', and 'रुपय'.

Handwritten notes on the right side of the page, including a signature and some illegible text.

Handwritten header text, possibly a title or date, in Hindi.

Handwritten text block, likely a paragraph or a list of items, in Hindi.

Handwritten text block, possibly a list or account entries, in Hindi.

Handwritten text at the bottom of the page, including a signature and illegible text.







Handwritten notes in Hindi, likely describing the features or details of the 10 Rupee note shown above. The text includes terms like 'भारत', 'भारतीय', 'एशोक स्तम्भ', 'आशोक स्तम्भ', 'भारत', 'भारतीय', 'एशोक स्तम्भ', 'आशोक स्तम्भ'.

A large block of handwritten text in Hindi, possibly a detailed description or a list of items, positioned below the notes on the left side of the page.

- 1894/1900 - 1900/1905  
 - 1905/1910 - 1910/1915  
 - 1915/1920 - 1920/1925  
 - 1925/1930 - 1930/1935  
 - 1935/1940 - 1940/1945  
 - 1945/1950 - 1950/1955  
 - 1955/1960 - 1960/1965  
 - 1965/1970 - 1970/1975  
 - 1975/1980 - 1980/1985  
 - 1985/1990 - 1990/1995  
 - 1995/2000 - 2000/2005  
 - 2005/2010 - 2010/2015  
 - 2015/2020 - 2020/2025  
 - 2025/2030 - 2030/2035  
 - 2035/2040 - 2040/2045  
 - 2045/2050 - 2050/2055  
 - 2055/2060 - 2060/2065  
 - 2065/2070 - 2070/2075  
 - 2075/2080 - 2080/2085  
 - 2085/2090 - 2090/2095  
 - 2095/2100 - 2100/2105

The first part of the document discusses the historical context of the project, starting with the early 1900s and moving through the mid-20th century. It highlights the challenges faced during these periods, such as limited resources and technological constraints. The text then transitions into a detailed description of the project's objectives and the methodology employed. This section includes a breakdown of the various phases and the specific tasks undertaken during each stage. The latter part of the document provides a comprehensive analysis of the results, comparing them against the initial goals and discussing the implications of the findings. It concludes with a summary of the key takeaways and recommendations for future work.

The first observations of marine life were made by early explorers. As they sailed across the open sea, they noticed various organisms that were different from those found on land. Some of these organisms were small and went unnoticed, while others were large and clearly visible. The study of marine life began in earnest in the 18th century when naturalists began to collect and describe the organisms they found.

In the 19th century, the study of marine life advanced significantly. Scientists began to use the microscope to study the smallest organisms, and they discovered that the sea was teeming with a vast array of life forms. The discovery of microorganisms in the sea was particularly important, as it showed that life could exist in the most unlikely of places.

The 20th century brought further advances in the study of marine life. Scientists began to use the techniques of molecular biology to study the genetics of marine organisms. This has allowed them to understand the relationships between different species and to trace the evolution of life in the sea.

Today, the study of marine life is a rapidly expanding field. Scientists are discovering new species at an ever-increasing rate, and they are beginning to understand the role of marine organisms in the global ecosystem. The study of marine life is not only a fascinating pursuit in its own right, but it is also one that has important implications for the future of our planet.

marine life  
 - algae  
 - seaweed  
 - fungi  
 - plants  
 - animals  
 - insects  
 - mollusks  
 - arthropods  
 - cnidarians  
 - chordates  
 - vertebrates  
 - mammals  
 - birds  
 - reptiles  
 - amphibians  
 - fish  
 - sharks  
 - whales  
 - dolphins  
 - seals  
 - sea turtles  
 - manatees  
 - dugongs

Geography - Europe

- major cities: London, Berlin, Paris, Rome, Athens, Moscow, Warsaw, Prague, Vienna, Budapest, Rome, Athens, Moscow, Warsaw, Prague, Vienna, Budapest
- major rivers: Rhine, Danube, Elbe, Oder, Vistula, Dnieper, Volga
- major mountains: Alps, Pyrenees, Carpathians, Apennines, Balkans
- major islands: Great Britain, Ireland, Sicily, Crete, Cyprus

The European continent is the second largest in the world, covering approximately 10.2 million square kilometers. It is bounded by the Atlantic Ocean to the west, the Mediterranean Sea to the south, and Asia to the east. The continent is divided into several major regions, including Western Europe, Central Europe, Eastern Europe, and Southern Europe. Each region has its own unique cultural, linguistic, and historical characteristics. The European Union (EU) is a major political and economic organization that includes many of the countries in the continent. The EU is responsible for creating a single market and a common currency, the Euro. The continent is also home to many of the world's most famous cities, including London, Paris, Rome, Athens, and Moscow. The European continent has a rich and diverse history, and it continues to play a major role in the world today.

Handwritten notes at the top of the page, including phrases like "Handwritten notes" and "Handwritten notes".

Large handwritten section, possibly a list or a detailed note, with some underlined words.

Handwritten notes in the middle section, including the phrase "Handwritten notes" and "Handwritten notes".

Handwritten notes in the lower middle section, including the phrase "Handwritten notes" and "Handwritten notes".

Handwritten notes at the bottom of the page, including the phrase "Handwritten notes" and "Handwritten notes".



THE PLAN SHOWING THE DIMENSIONS OF PLOTS

OF C.S. PLOT NO 876, 878 OF MOUJA RAHARPS, KHARDAHA DISTRICT

THE PURCHASED LAND IS DEMARCATED BY RED INK.

SCALE 1" = 30 FT.

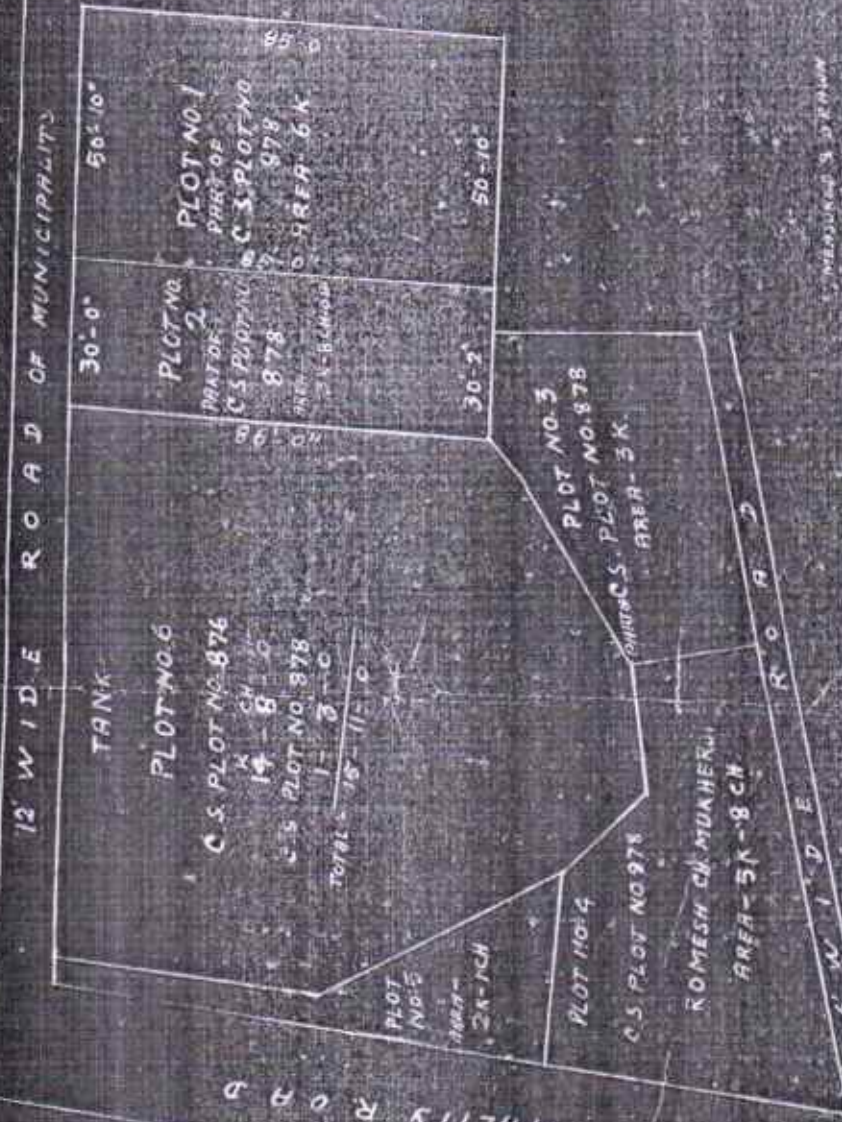

25 WIDE MUNICIPALITY ROAD

INDEX

PLOT NO.	AREA OF PLOT	TOTAL AREA
1	0-6-0-0	0-6-0-0
2	0-3-8-0	0-3-8-0
3	0-3-0-0	0-3-0-0
4	0-5-8-0	0-5-8-0
5	0-2-1-0	0-2-1-0
6	0-1-3-0	0-1-3-0
7	0-14-8-0	0-14-8-0
		1-15-12-0